

DRØMMEHAGEN : DRØBAK, NORWAY

APTIO



EUROPEAN  
HEALTHCARE  
DESIGN 2017

**NORWEGIAN LIVING FOR A GENERATION DEFINED BY  
WHO THEY ARE AND HOW THEY LIVE THEIR LIVES,  
NOT HOW OLD THEY ARE**

**SITE RESPONSE - DRØBAKISM**

**ARCHITECTURE & URBAN DESIGN**

**STAYING ACTIVE**

**COMMUNITY**

**AMENITIES**



# Location

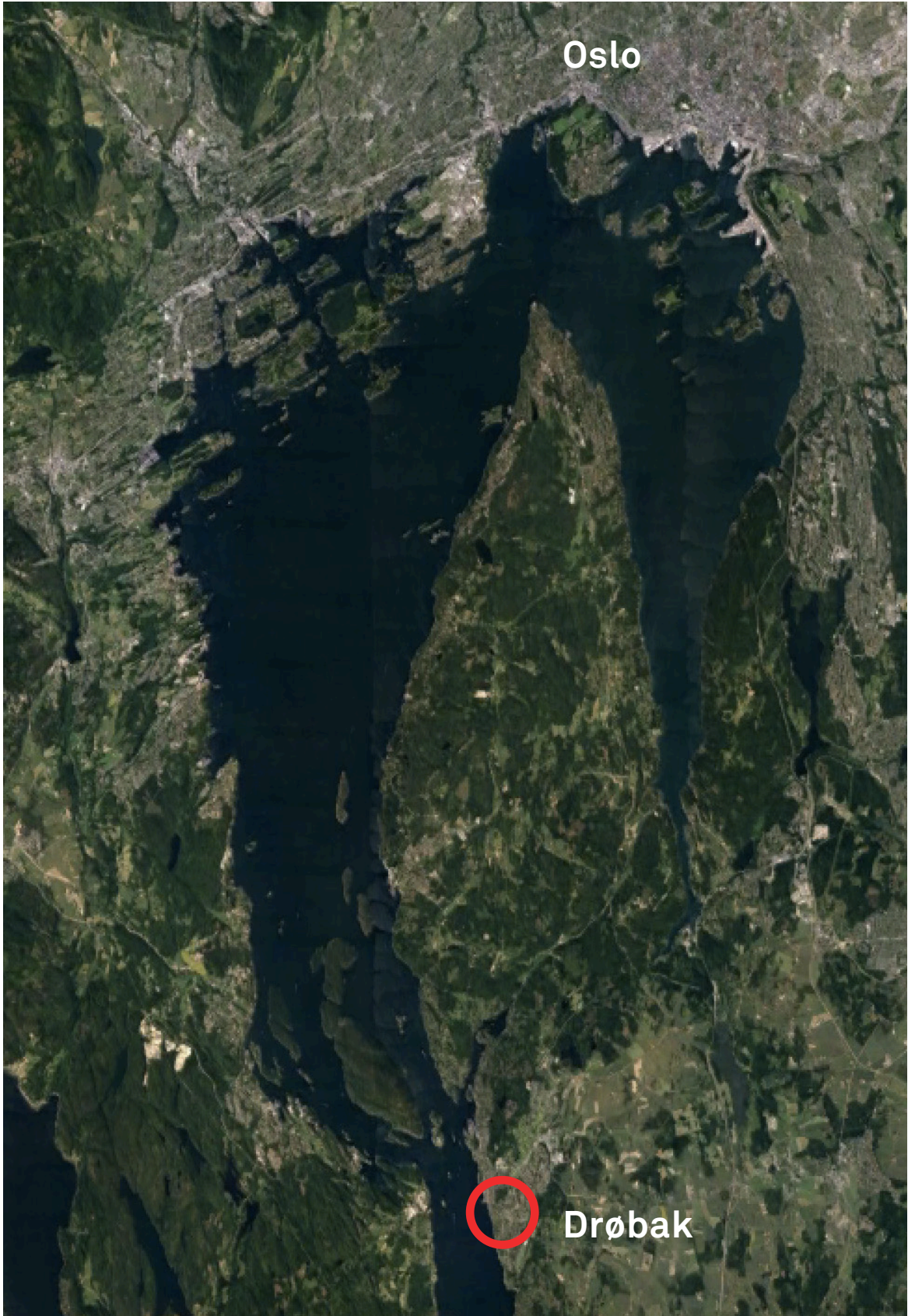











# Site Response

Good sunlight conditions

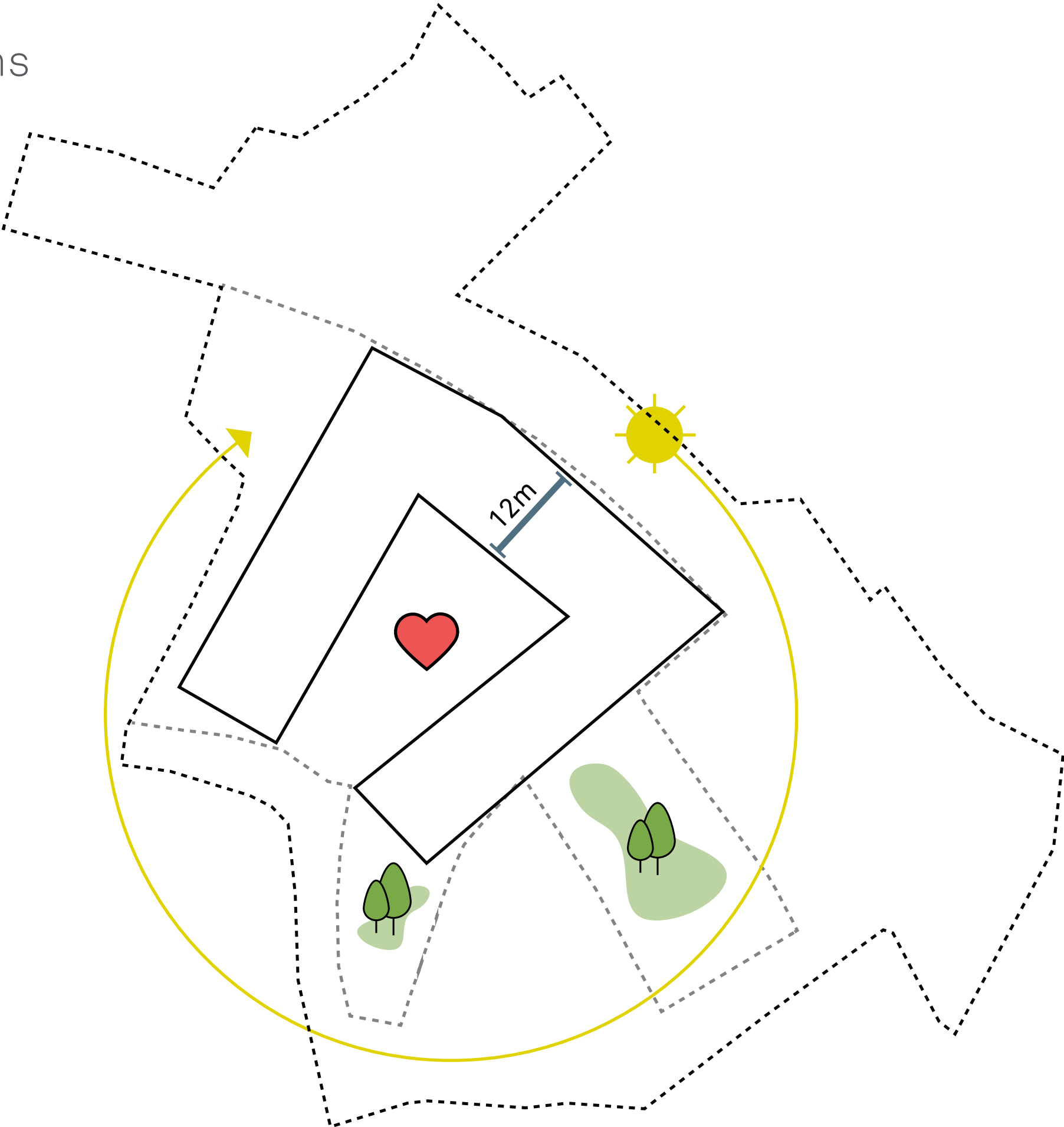



# Site Response

## Permeability

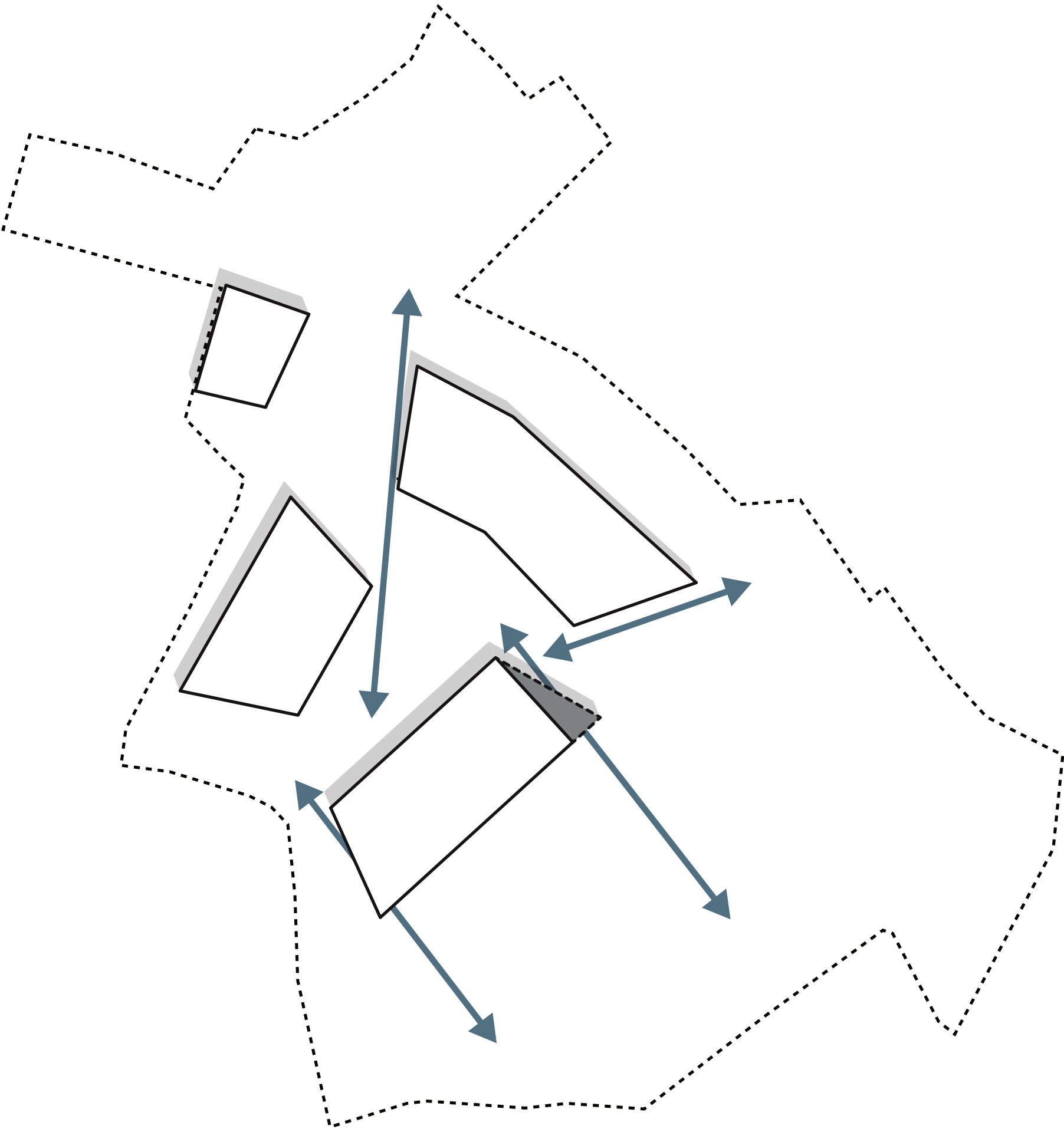



# Site Response

Character

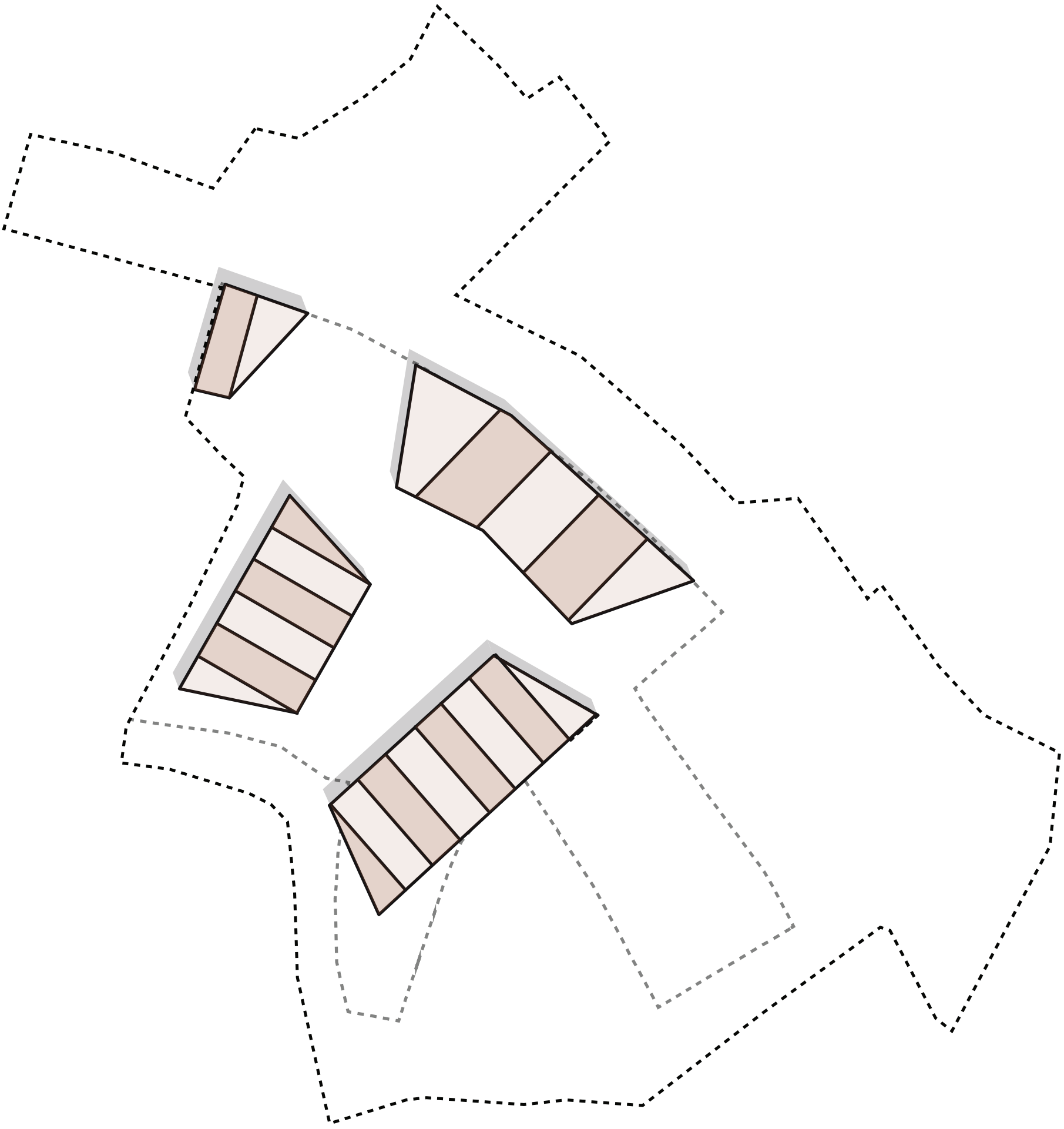

# Site Response

Flexibility

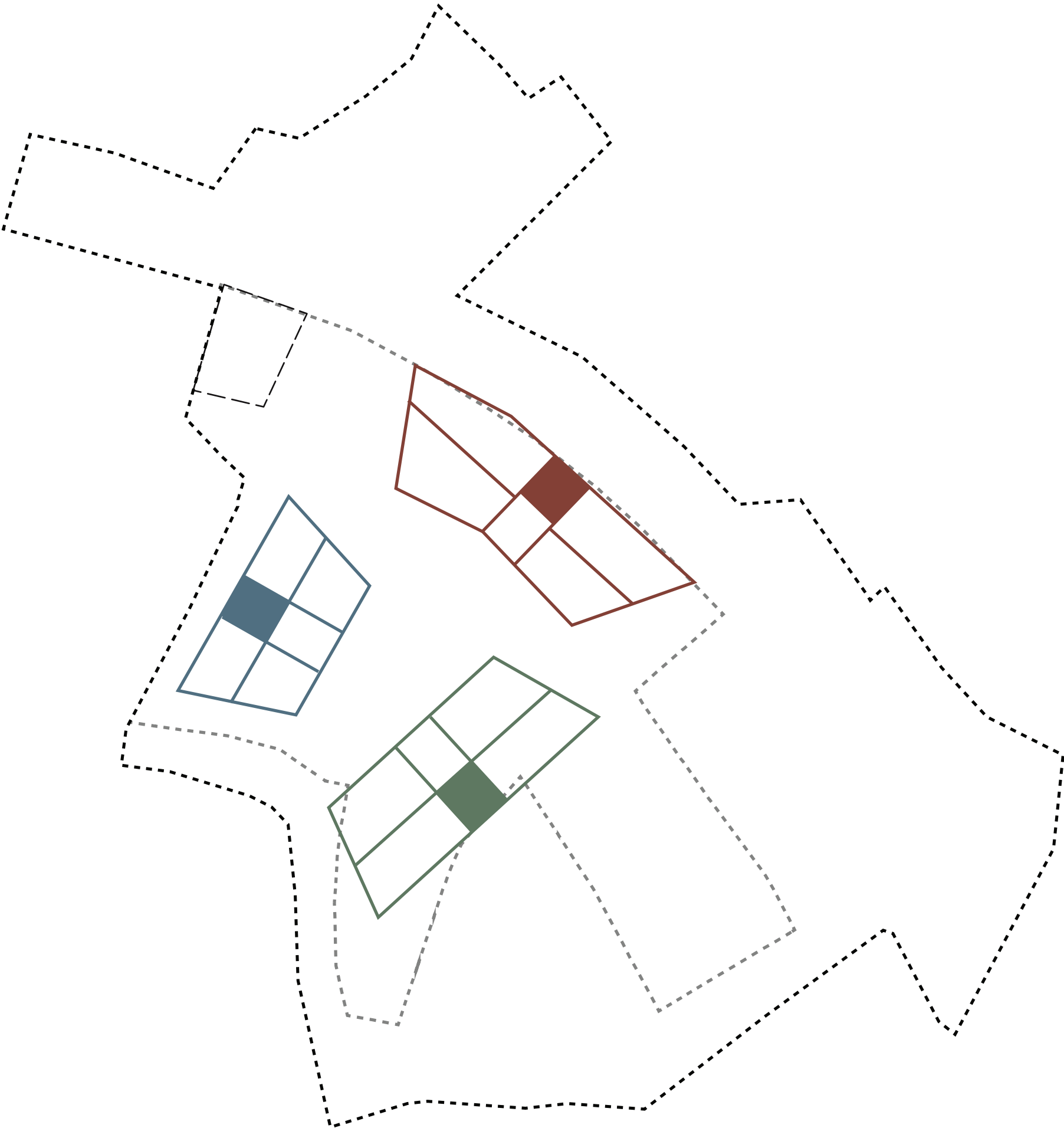



# Site Response

Active Frontages & Amenities

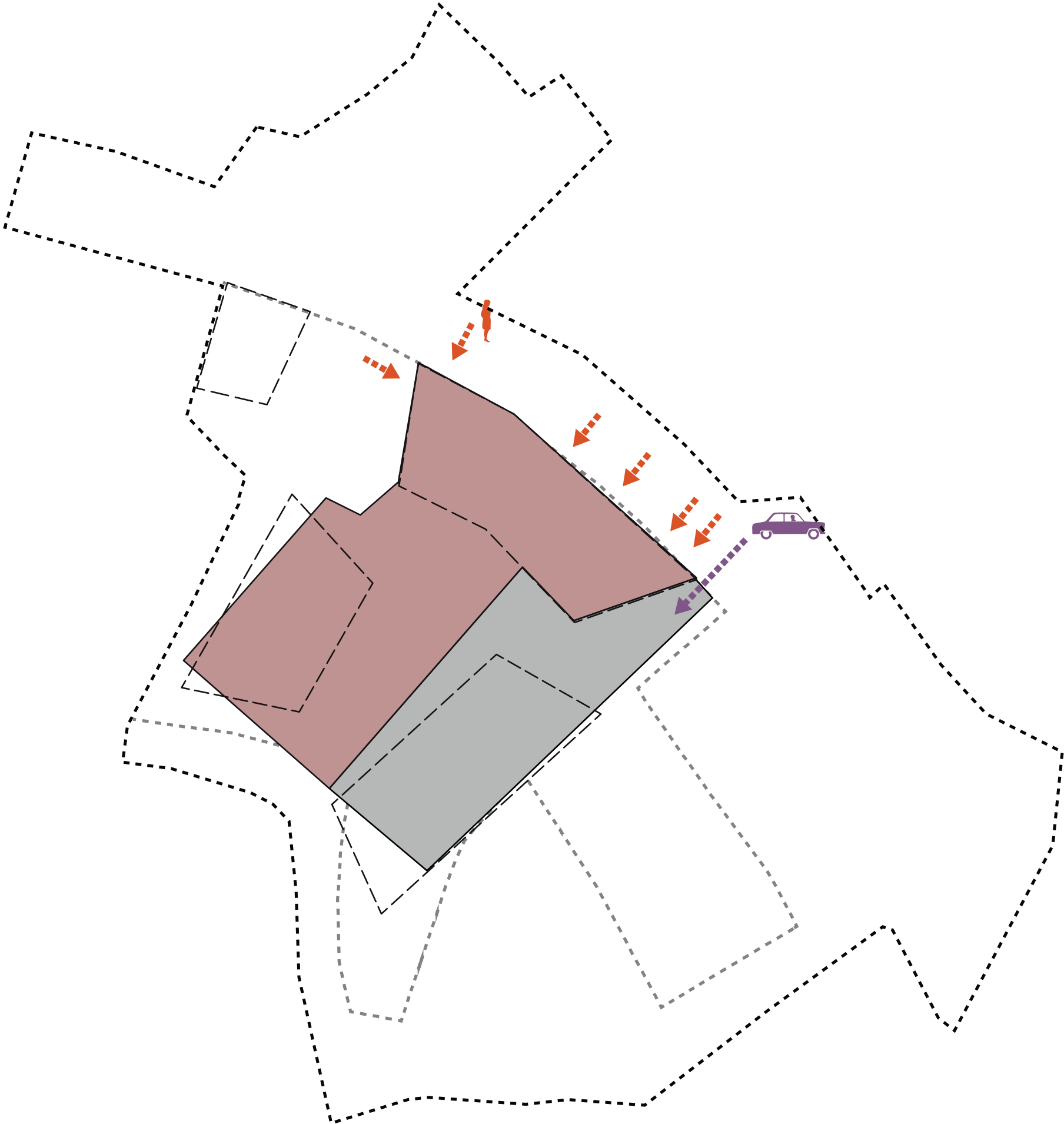

# Site Response

## Landscape





[illegible]







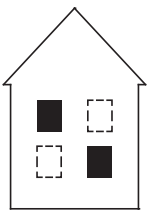

TYPOLGY  
Wooden House



TYPOLGY  
Two elevated  
storeys



TYPOLGY  
Side and roof  
extensions

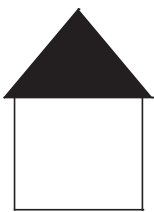

ROOFSCAPE  
Gable

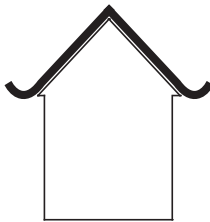

ROOFSCAPE  
China-tilt

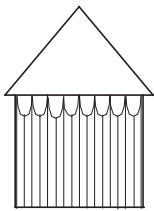

MATERIALS  
Timber  
and details  
ornaments

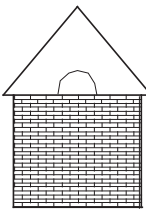

MATERIALS  
Brick, glazed  
facade

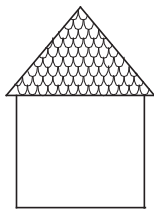

MATERIALS  
Brick on roof

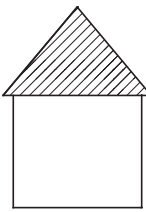

MATERIALS  
Brick on roof

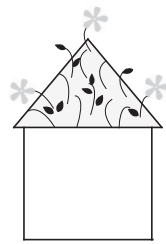

MATERIALS  
Green roof



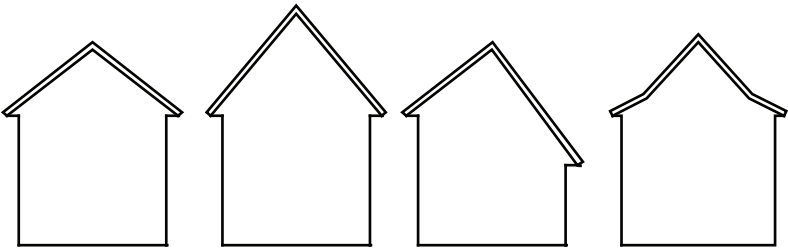

Existing roof profiles on surrounding buildings

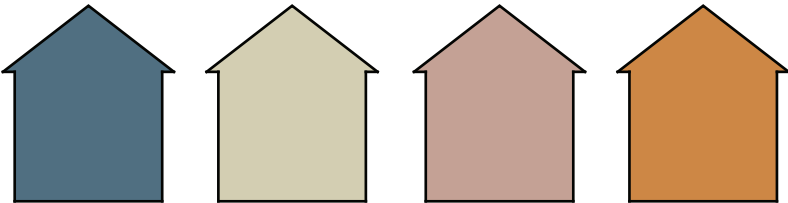

Colour use on surrounding buildings

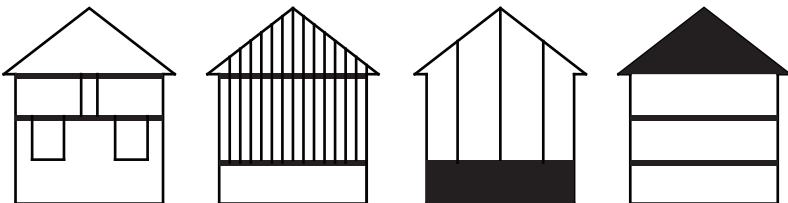

Horizontal / vertical datums in surrounding facades

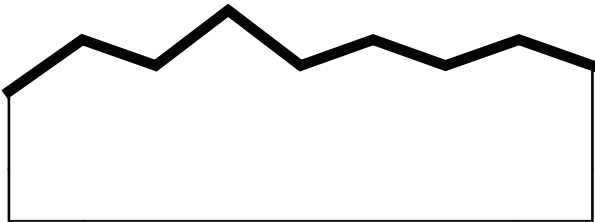
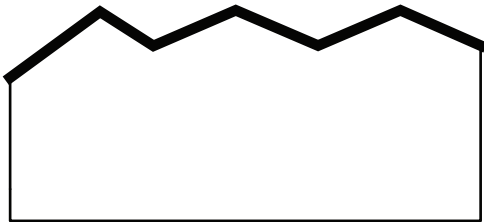
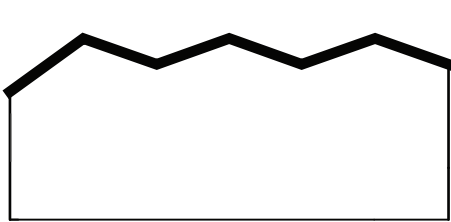

Roofscape

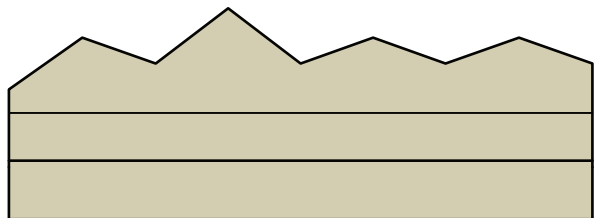
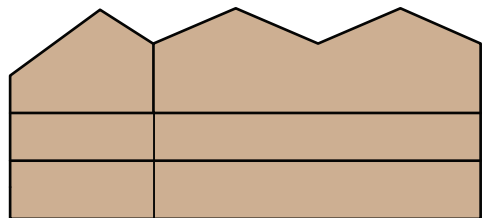
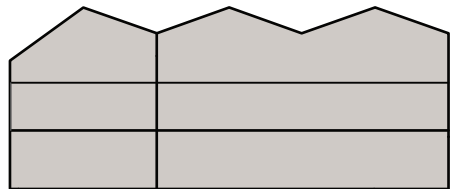

Volume  
distribution and  
colour use

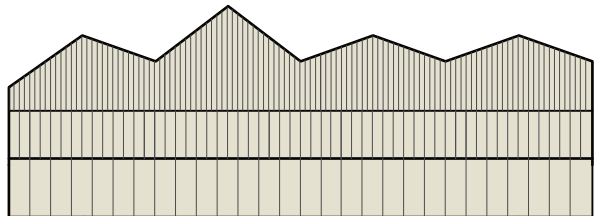
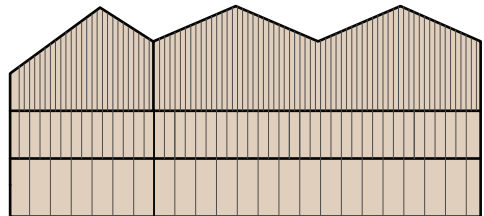
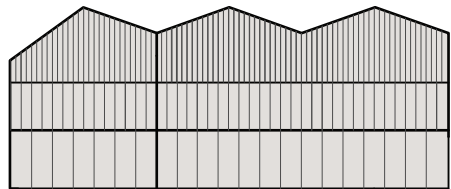

Roofscape and horizontal  
/ vertical expression in the  
facades







# Scale & Knitting in

EUROPEAN HEALTHCARE DESIGN / JUNE 2017













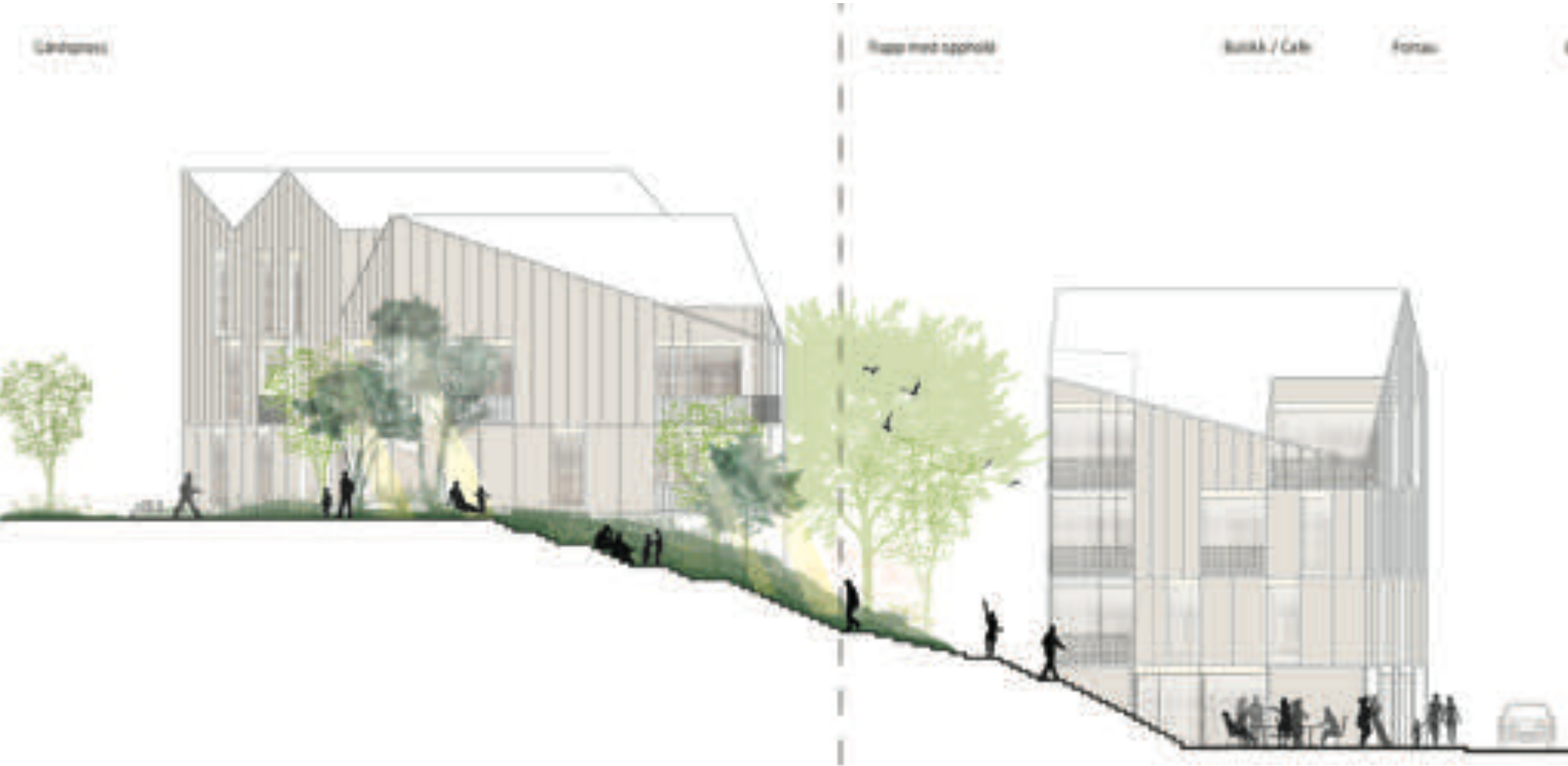

# Landscape

Connecting with the community

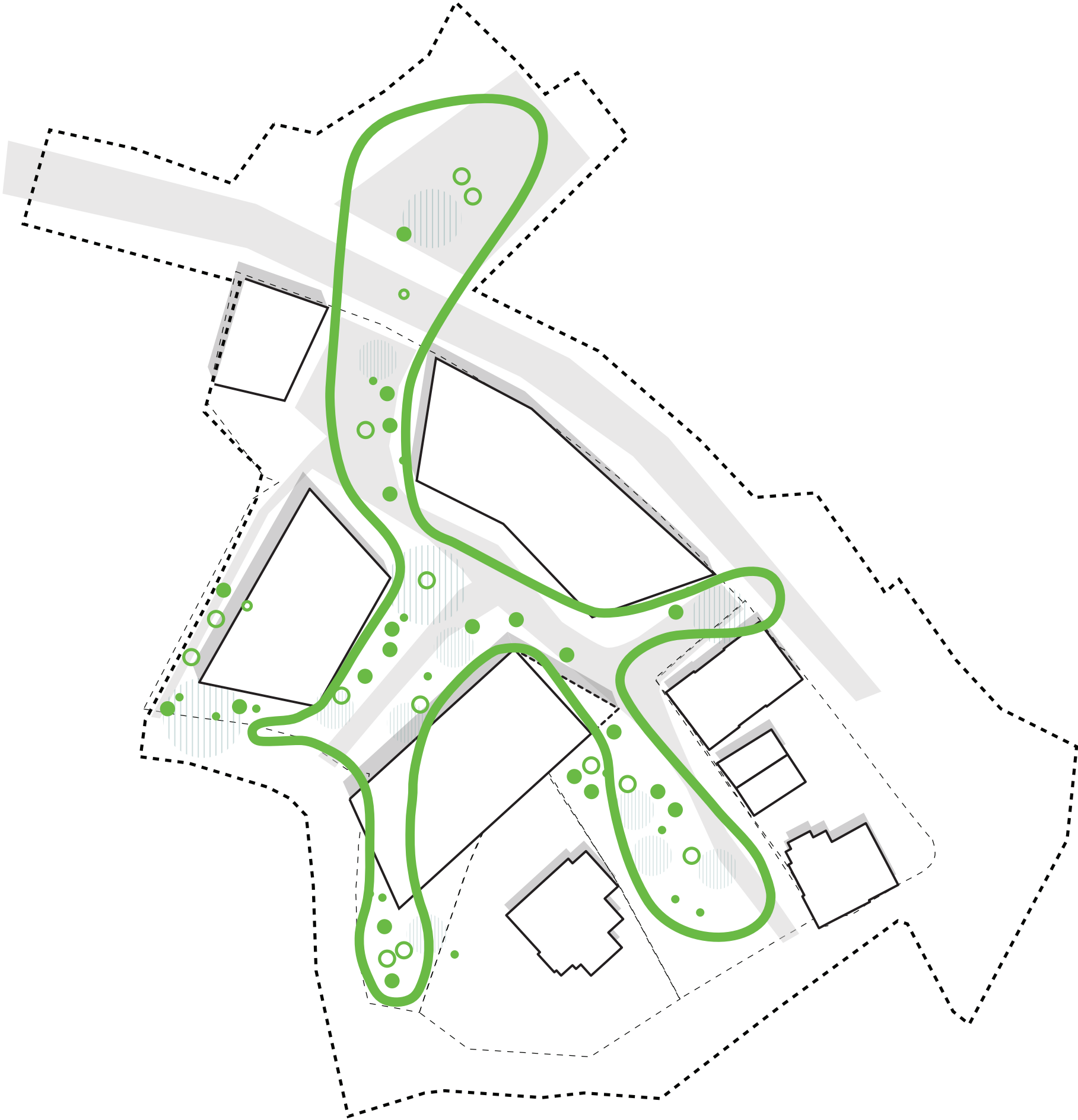

# Landscape Zones

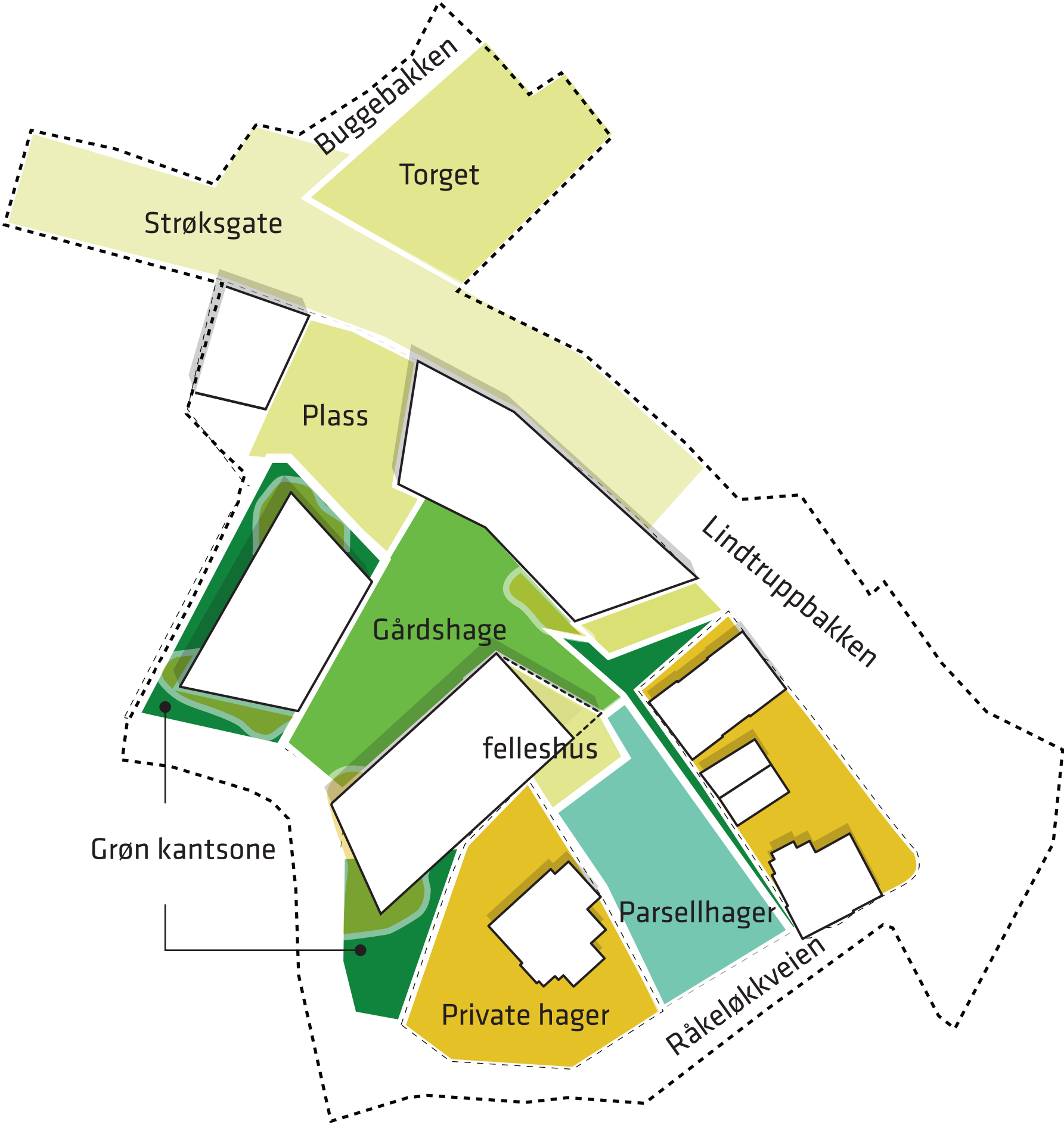



Landscape  
Permeability

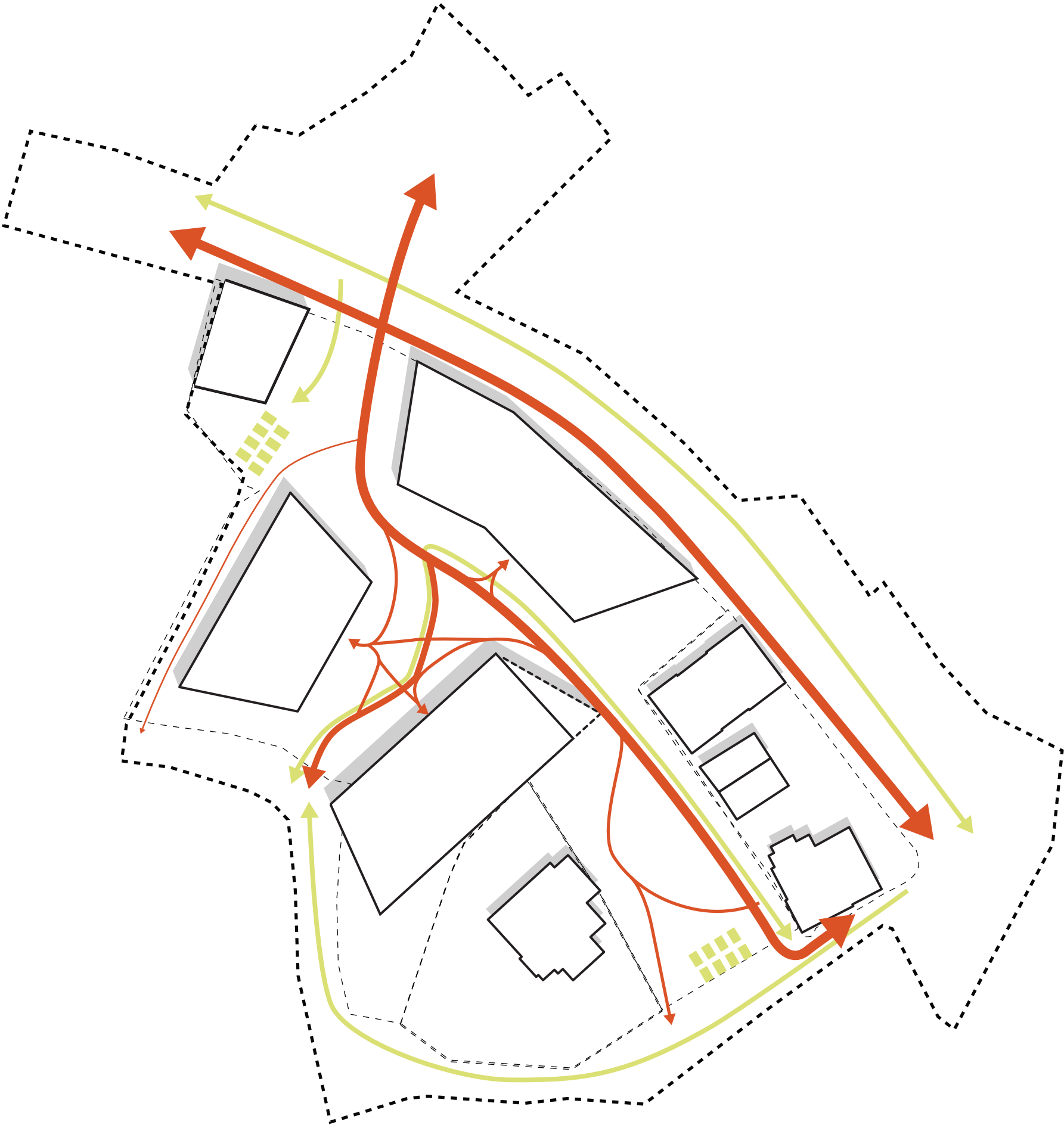

Landscape  
Private - Public

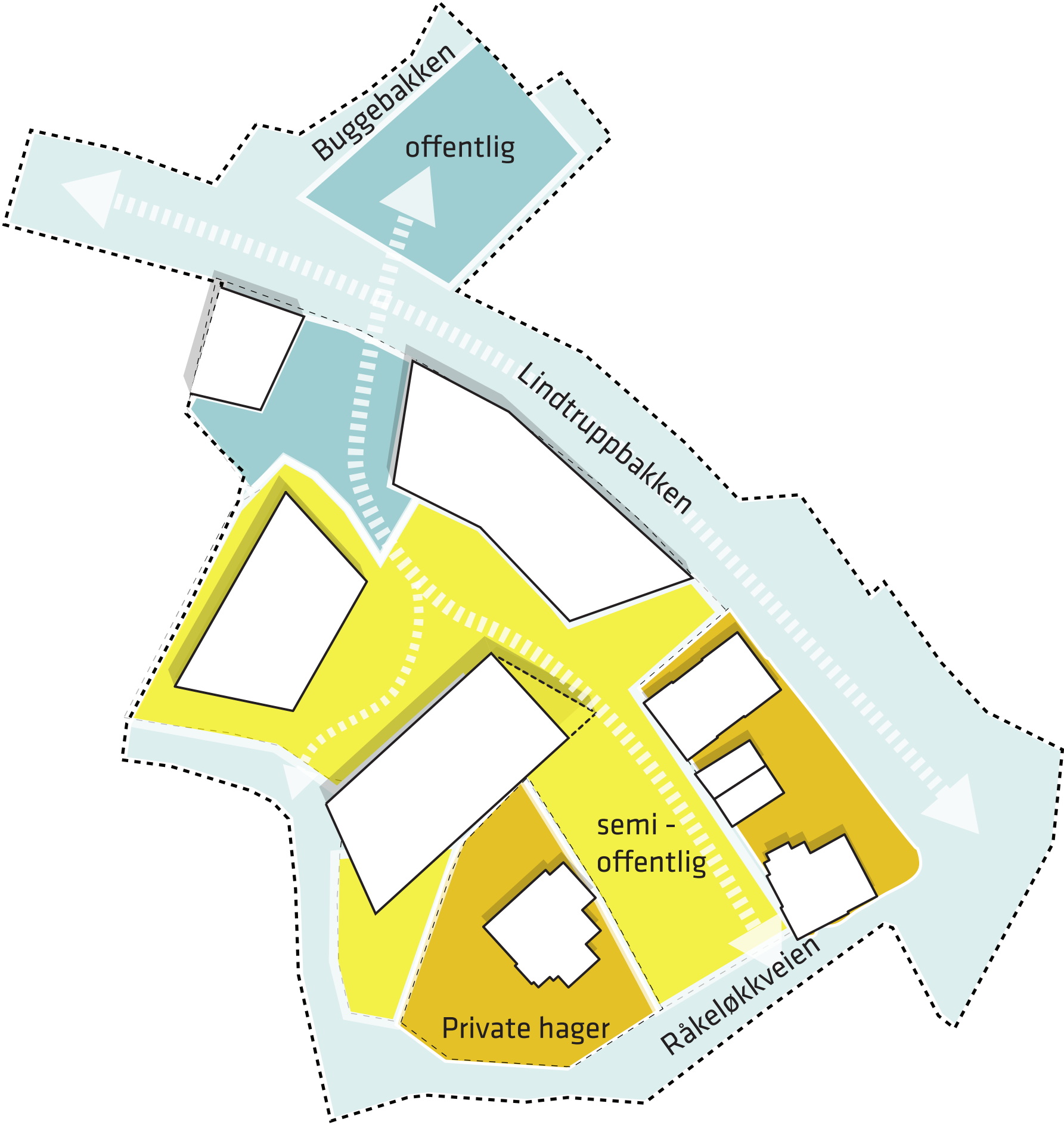







# New Town Square

## Community









# Communal Lounge





Thank you



NAPTIC